



The Glamping Ratus



The Glamping Ratus,

The Glamping Ratus project is designed as a modern retreat in nature, intended for relaxation and reconnection with the surrounding environment. The complex includes six holiday cabins, harmoniously integrated into the landscape, offering contemporary amenities in a natural setting. Each unit features a main room, anteroom, bathroom, and terrace, designed for comfort and functionality.

The Layout

The complex layout follows the natural topography of the land, respecting the existing relief and vegetation. The cabins are positioned along paved alleys, ensuring easy access and privacy for each unit. A central feature of the complex is the recreation area with an outdoor fire pit, creating an ideal space for socializing and relaxation.

Each modular unit is designed as a compact space with well-defined functionalities, including:

- Living Area: serves as both a relaxation and sleeping zone;
- Bathroom;
- Anteroom;
- Storage and access areas designed for efficient organization;
- Terrace: An outdoor extension providing a private relaxation area.

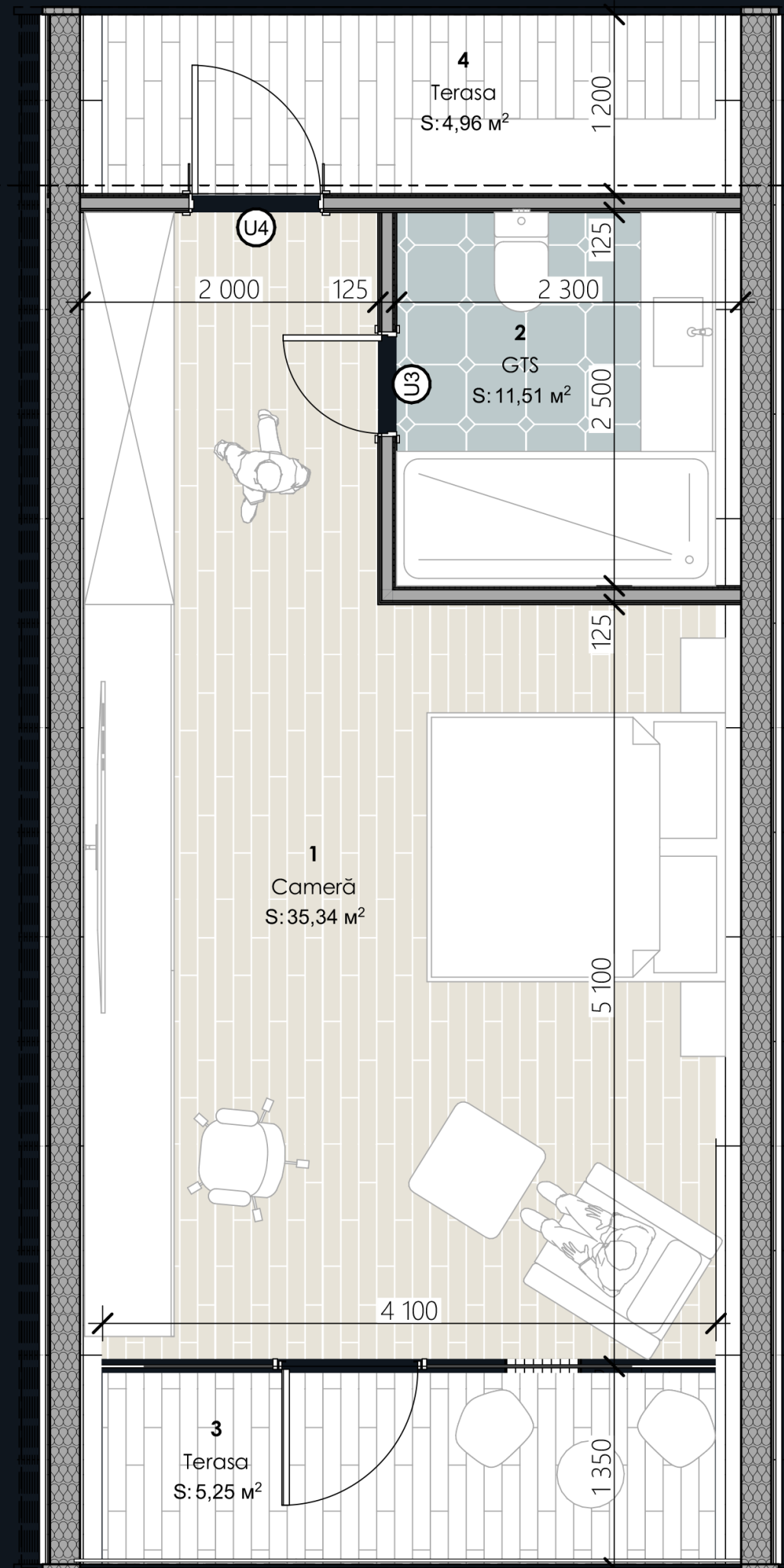

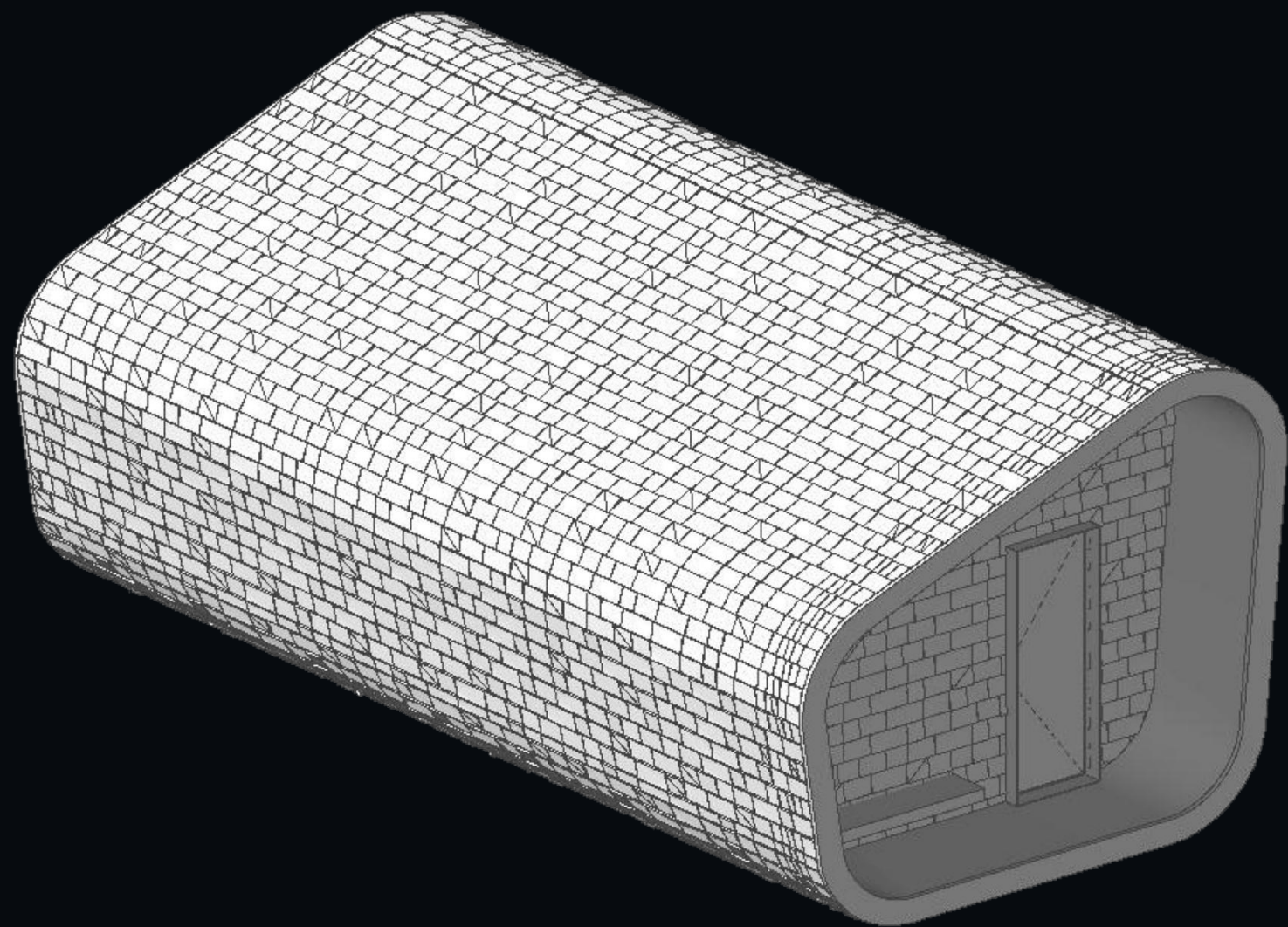
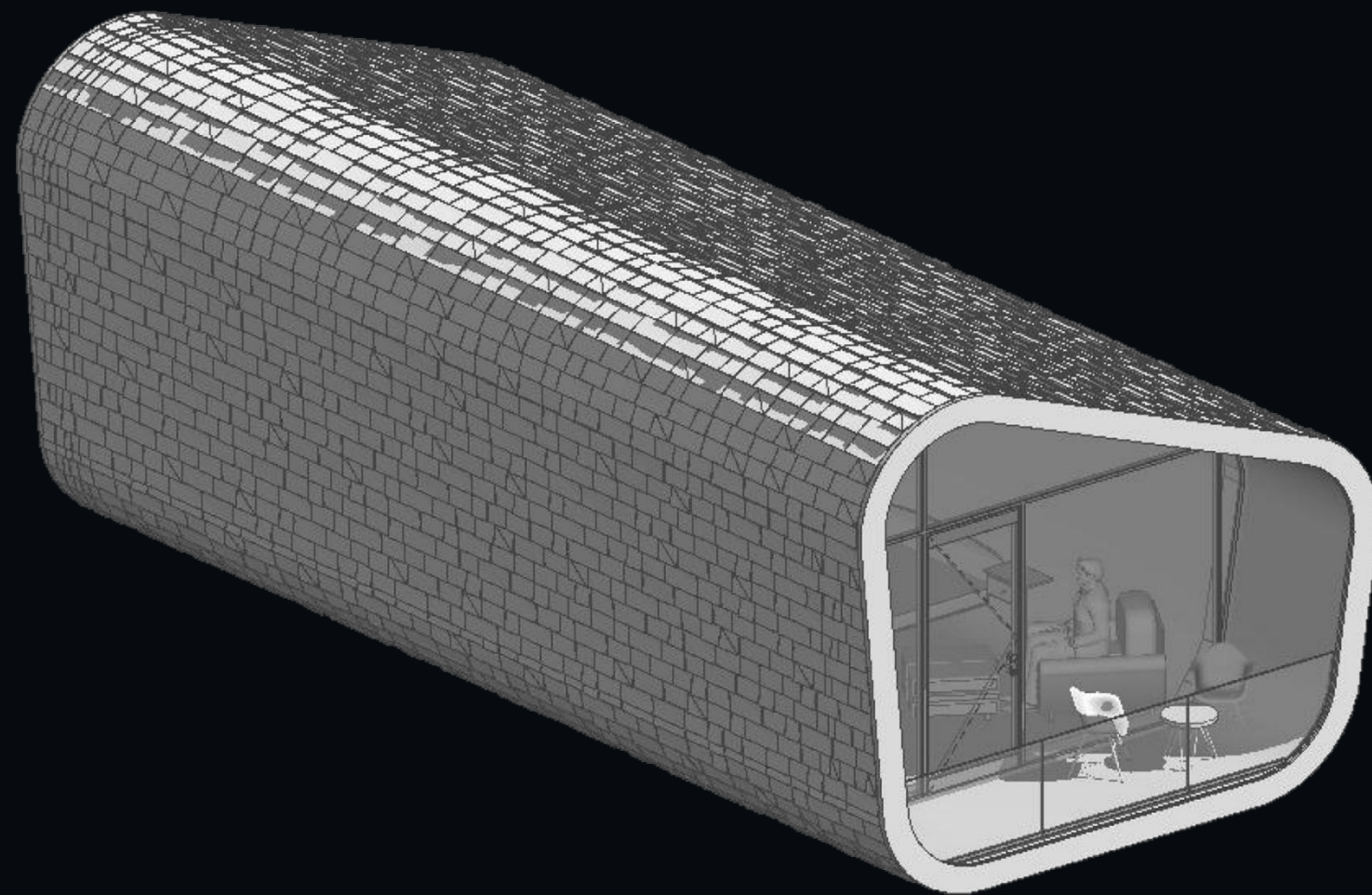
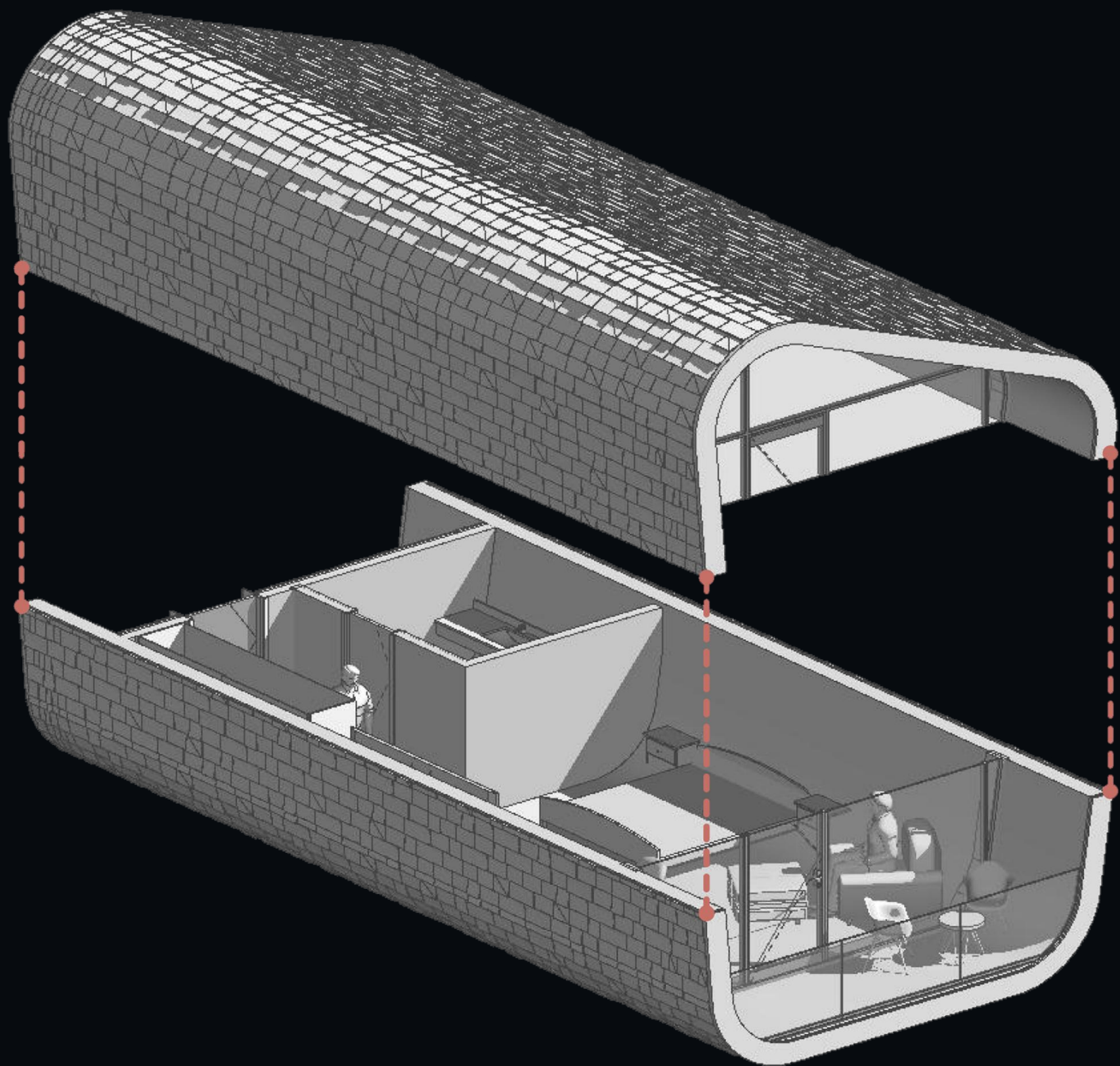



Challenge

The design of the cabins is inspired by organic forms, featuring fluid lines and natural finishes that blend seamlessly into the landscape. The facades are clad in wooden shingles, complemented by elegant metal frames that highlight the contours of the volumes. Generous glazed surfaces provide abundant natural light and create visual continuity between the interior and exterior. The modular structures are elevated on metal pillars to minimize impact on the soil and preserve the natural character of the land.



Concept

The architectural concept is based on organic integration into nature, creating a symbiosis between the structures and the landscape. The project prioritizes sustainability by using eco-friendly materials and energy-efficient construction solutions. The modular forms and minimalist design ensure a contemporary aesthetic, adaptable to the varied landscape. Private terraces and panoramic windows are designed to provide spectacular views and maximize the connection with nature. The module is designed to be easily transported and assembled, offering flexibility for temporary or permanent developments.



We created a glamping site in Ratuș to offer a unique, nature-immersive experience that combines the comfort of modern amenities with the beauty and tranquility of the Moldovan countryside. Ratuș is blessed with picturesque landscapes, rich cultural heritage, and a peaceful atmosphere-making it an ideal destination for eco-tourism and relaxation. Our goal was to attract both local and international visitors seeking authentic, sustainable travel experiences. By developing glamping accommodations, we aimed to diversify rural tourism, support the local economy, and promote environmental awareness. Glamping in Ratuș allows guests to enjoy outdoor adventures, local traditions, and community hospitality, all while minimizing their ecological footprint.