

Architecture lab

+ **more**

june,
2025

UNDS





introduction

"Architecture Lab & More" is a multifunctional space that combines an architecture laboratory with a dedicated area for travel services. Designed to support the internal operations of the OXIDE Creative Lab studio, this space originated as an inspiring and dynamic environment conceived by two friends and colleagues united by their passion for architecture and design.

The minimalist, purpose-driven design is accentuated by the use of oxide red—a color chosen for its emotional resonance and connection to the earth. This vibrant hue not only enhances the space's visual appeal but also fosters collaboration and sparks creativity, making it an ideal environment for generating new ideas.



floor plan

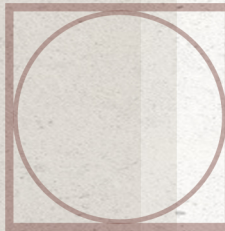
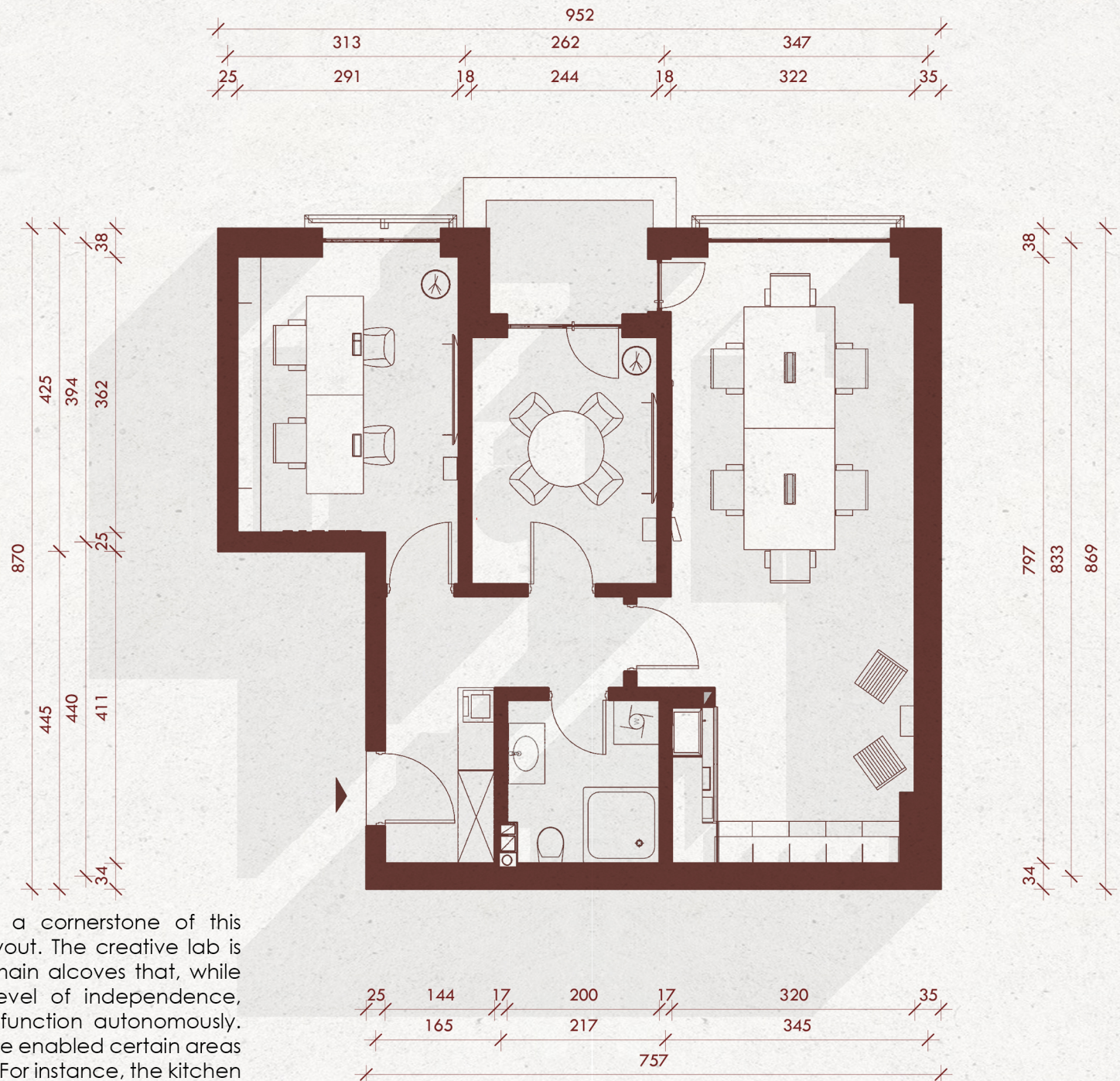

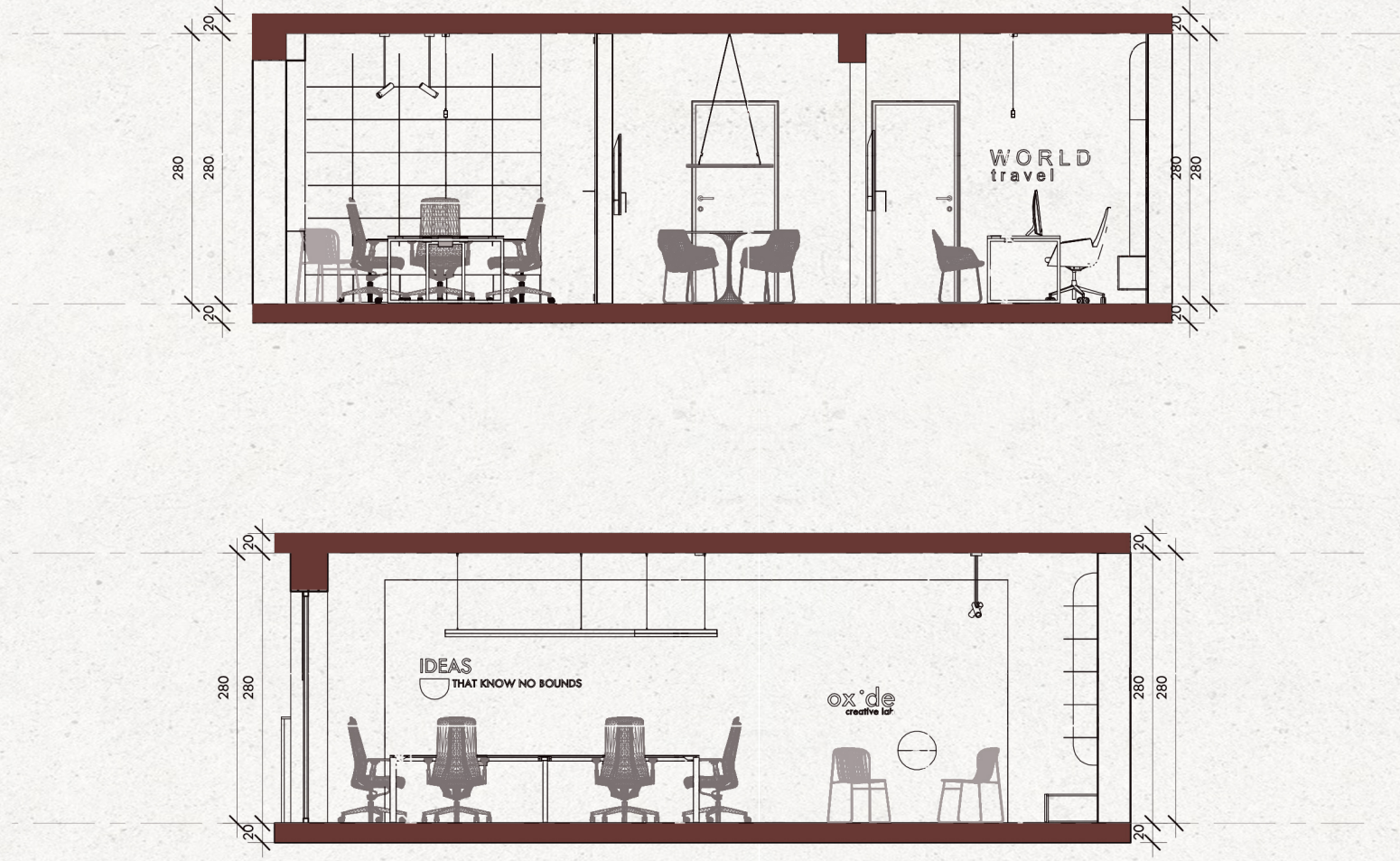

sections

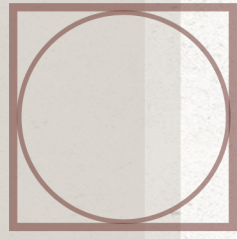

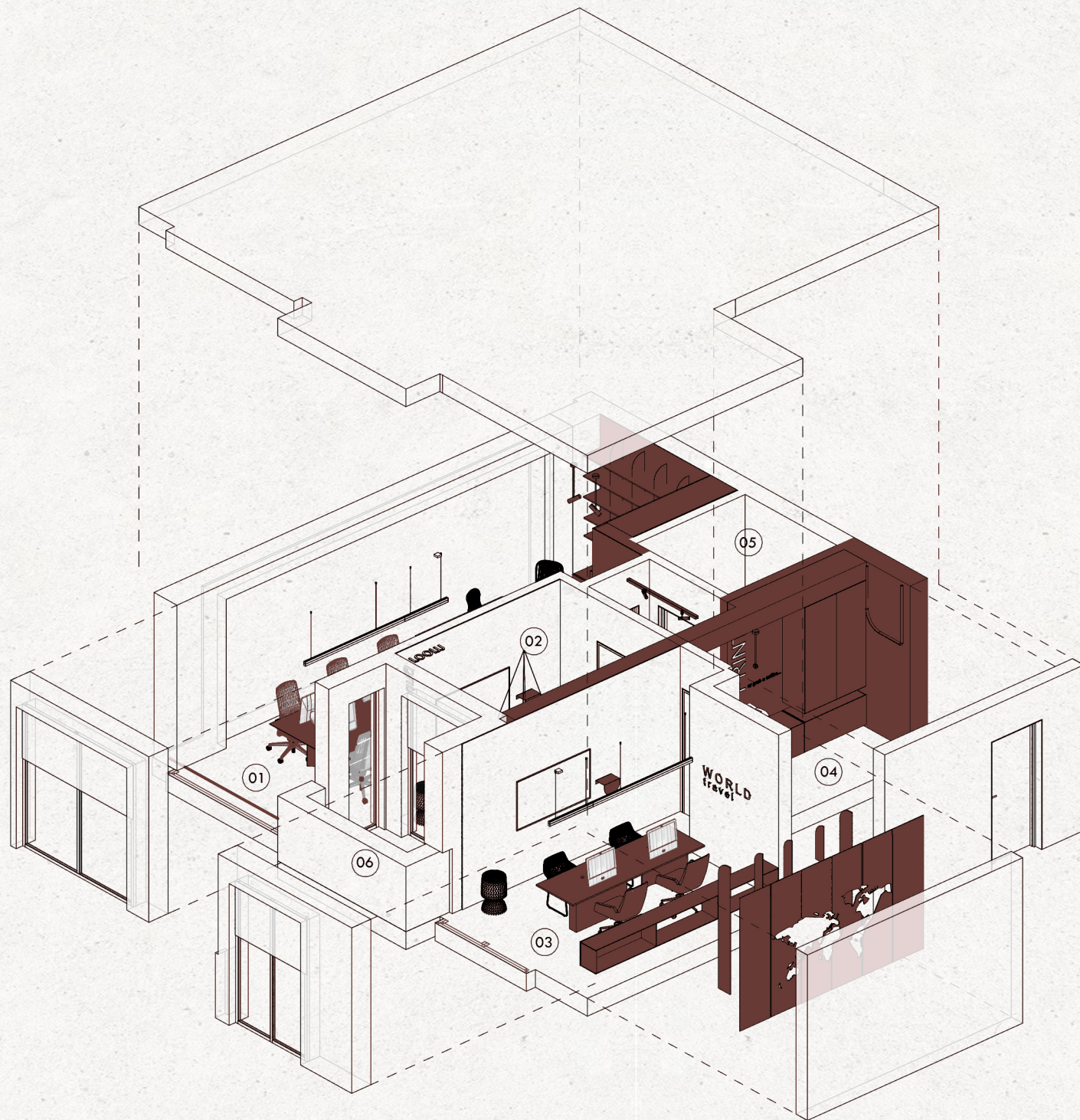

axonometry





01



Technical drawing of a rectangular frame, oriented vertically. The drawing includes dimensions and annotations:

- Overall Dimensions:**
 - Top: 57.5, 15, 57.5 (Total: 130)
 - Right: 18, 39, 39, 39, 39, 39, 18 (Total: 310)
 - Bottom: 15, 6, 41, 6, 41, 6, 15 (Total: 130)
 - Left: 15, 6, 14, 6, 33, 6, 33, 6, 33, 6, 33, 6, 33, 6, 33, 6, 310 (Total: 310)
- Internal Dimensions and Annotations:**
 - Top-left corner: 95, 30, 16.5, 7.5
 - Top-right corner: 73, 52, 5, 5, 7.5
 - Center: 80, 75, 5, 5, 100
 - Bottom-left corner: 135, 30, 6.5, 7.5
 - Bottom-right corner: 76, 10, 100
 - Bottom: 15, 6, 41, 6, 41, 6, 15 (Total: 130)
- Annotations:**
 - Top: B
 - Right: A
 - Bottom: B
 - Left: A

Technical drawing of a 310mm wide, 75mm high profile. The drawing shows a cross-section with a total width of 310mm and a total height of 75mm. The profile features a central rectangular cutout with a width of 80mm and a height of 70.2mm. The top flange has a thickness of 4mm. The bottom flange has a thickness of 7.0mm. The drawing includes various dimensions and tolerances:

- Top flange width: 310mm
- Top flange thickness: 4mm
- Central cutout width: 80mm
- Central cutout height: 70.2mm
- Bottom flange thickness: 7.0mm
- Dimensions and tolerances (from left to right): 15^{+0.15}_{-0.10}, 6^{+0.10}_{-0.05}, 33^{+0.10}_{-0.05}, 6^{+0.10}_{-0.05}, 33^{+0.10}_{-0.05}, 6^{+0.10}_{-0.05}, 33^{+0.10}_{-0.05}, 6^{+0.10}_{-0.05}, 33^{+0.10}_{-0.05}, 6^{+0.10}_{-0.05}, 33^{+0.10}_{-0.05}, 6^{+0.10}_{-0.05}, 33^{+0.10}_{-0.05}, 6^{+0.10}_{-0.05}, 14^{+0.10}_{-0.05}, 6^{+0.10}_{-0.05}, 14^{+0.10}_{-0.05}, 15^{+0.15}_{-0.10}

office furniture

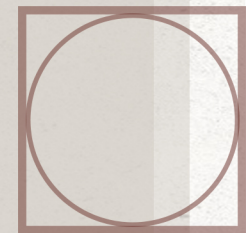

PLAN:

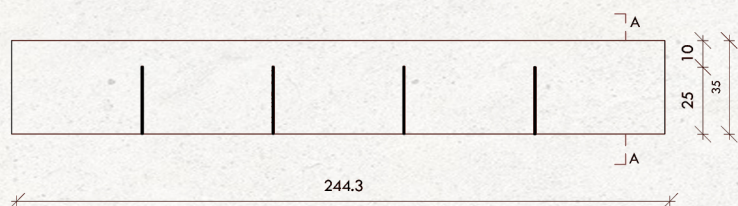

Basic yet refined materials, such as metal sheets coated in oxide red, bring cohesion and subtle vibrancy throughout the lab. The metal sheeting, applied consistently across the space, adds dynamism and a sense of excitement to the environment.



metal shelf detail

3D VIEW:

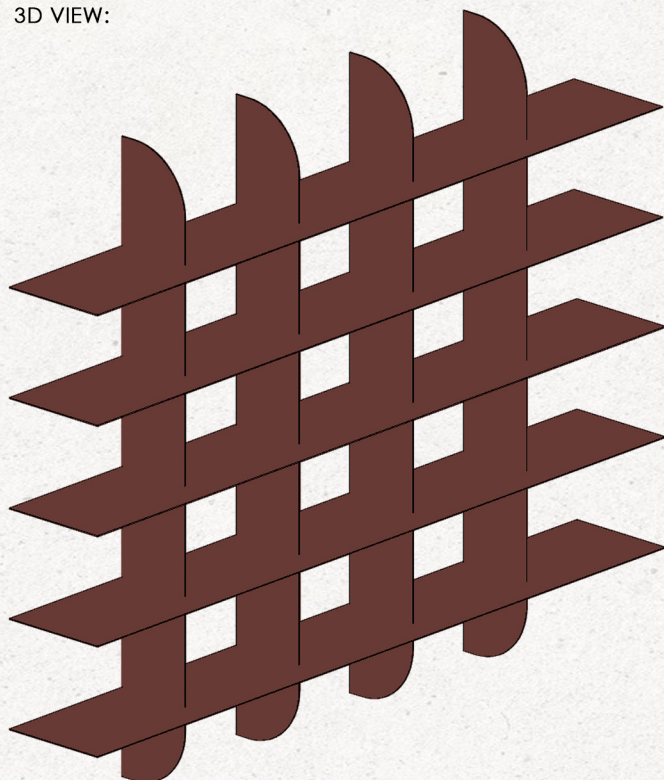

SECTION A-A:

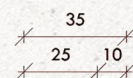

3D VIEW:

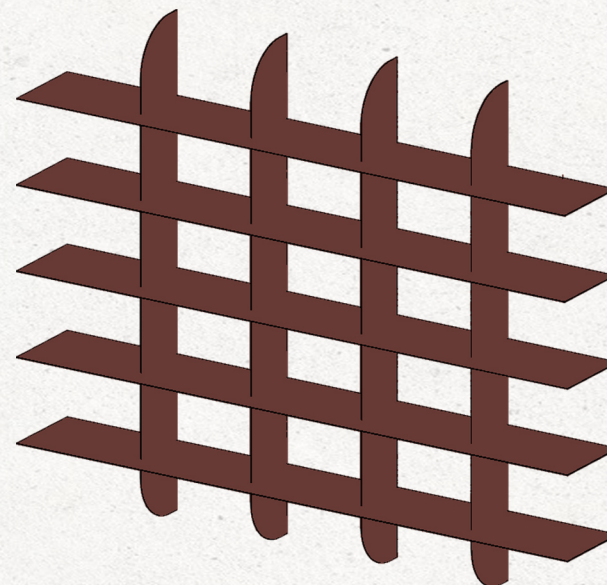



02

IF NOT
NOW
THEN
WHEN
?



Technical drawing of a mechanical part, showing two views: a front view (top) and a top view (bottom).

Front View (Top):

- Overall diameter: 100
- Central vertical slot width: 10
- Horizontal slot width: 42
- Horizontal slot depth: 10
- Horizontal slot radius: R 50
- Horizontal slot radius: R 25
- Horizontal slot radius: R 18
- Horizontal slot radius: R 28

Top View (Bottom):

- Overall diameter: 100
- Central vertical slot width: 10
- Horizontal slot width: 42
- Horizontal slot depth: 10
- Horizontal slot radius: R 50
- Horizontal slot radius: R 25
- Horizontal slot radius: R 18
- Horizontal slot radius: R 28

such as metal, wood, paper and dimension, cast.

Architecture lab
+more

3D VIEW:

IF NOT NOW THEN WHEN ?



One of the standout features is the use of philosophical narratives, flowing from one alcove to another, each carrying its own meaningful message. The letters serve as both decorative accents and content-rich design elements, embedding deeper meaning within the space.



03

WORLD
travel



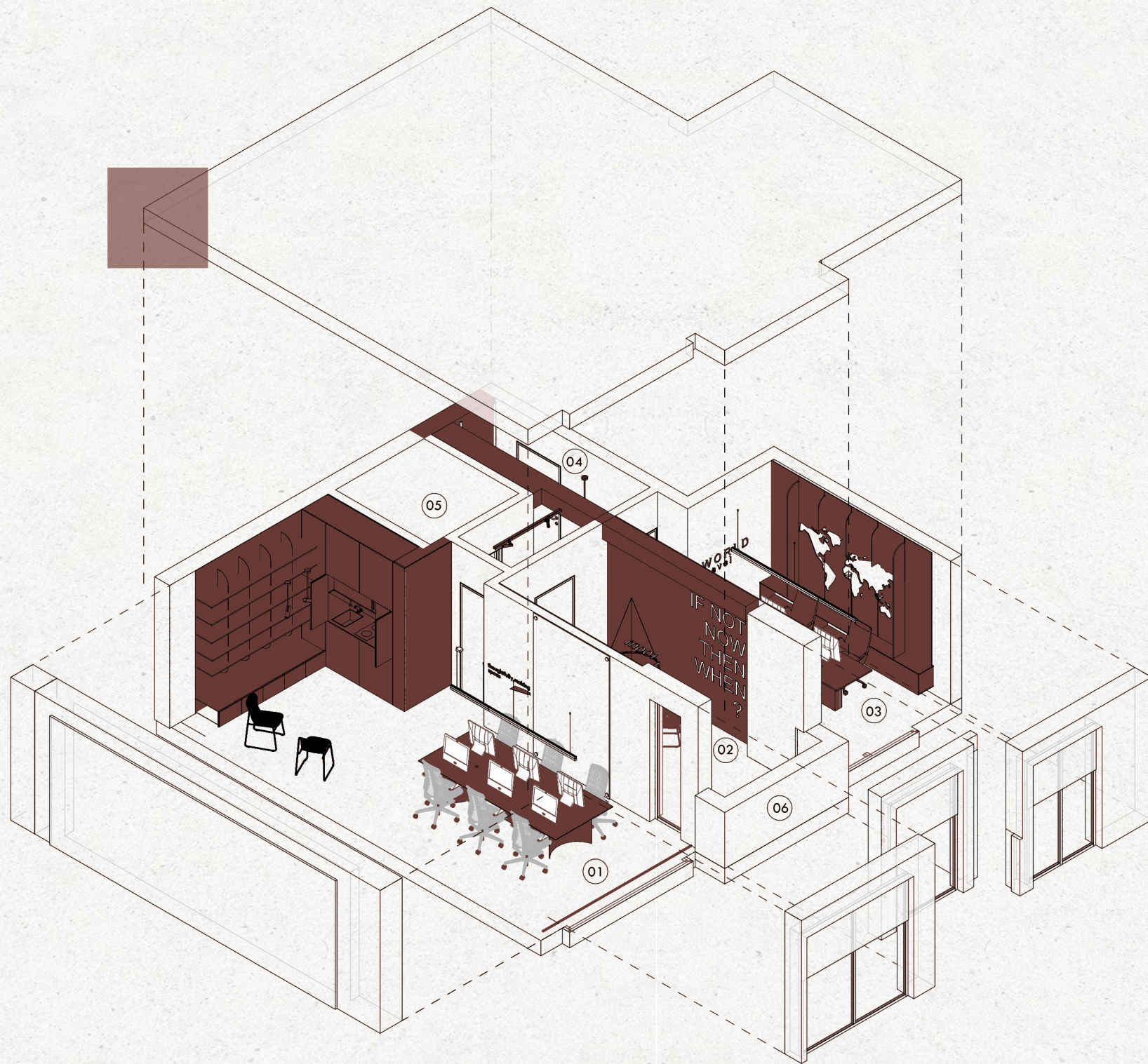

axonometry



[illegible]

A world map showing the distribution of the number of countries with a specific number of languages. The map is divided into regions, each labeled with a number representing the count of countries. The regions and their counts are: North America (61.5), South America (119.4), Europe (71.8), Africa (236.6), Asia (63.9), and Australia (38.8). The total number of countries is 362.

3D VIEW:

crafted on the philosophy that design should
ples of architecture: functionality, aesthetic
impact.

A 3D perspective view of a world map mounted on a wall. The wall is a light beige color with a subtle, organic texture. The map is a dark brown silhouette of the world's continents. The map is divided into three vertical sections by two thin, dark vertical lines. The perspective is from a low angle, looking up at the map, which creates a sense of depth and scale. The map is slightly tilted, and the lighting is soft, casting gentle shadows that emphasize the three-dimensional quality of the installation.

Architecture lab
+more

PLAN:

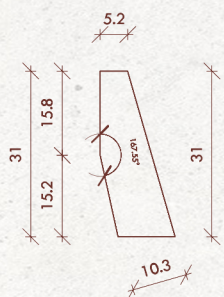

FRONT ELEVATION:

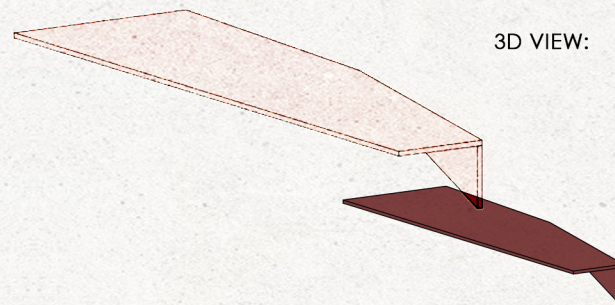
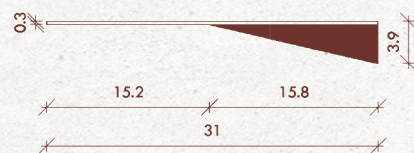

3D VIEW:

PLAN:

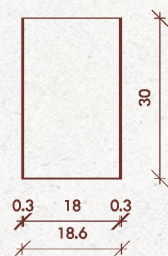

FRONT ELEVATION:

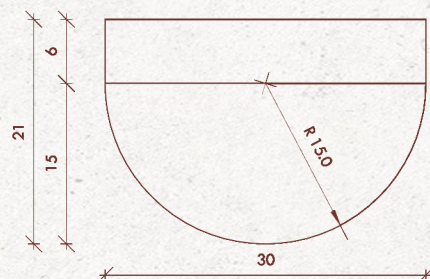

3D VIEW:

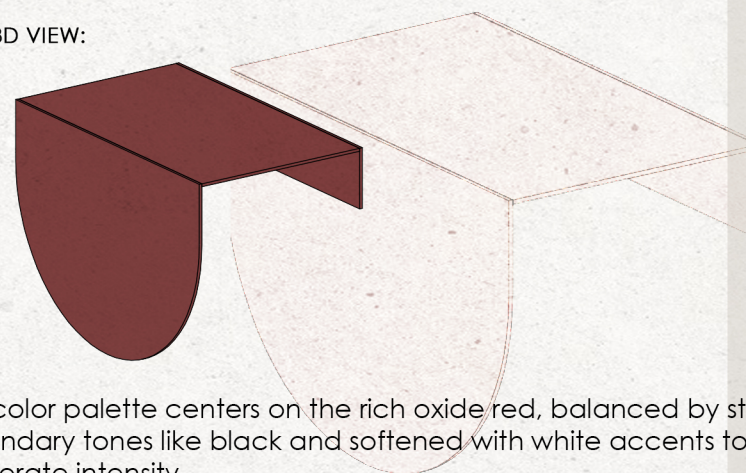

The color palette centers on the rich oxide red, balanced by strong secondary tones like black and softened with white accents to moderate intensity.

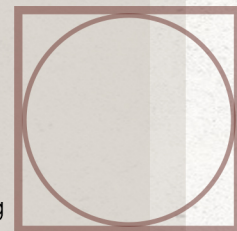

PLAN:



FRONT ELEVATION:

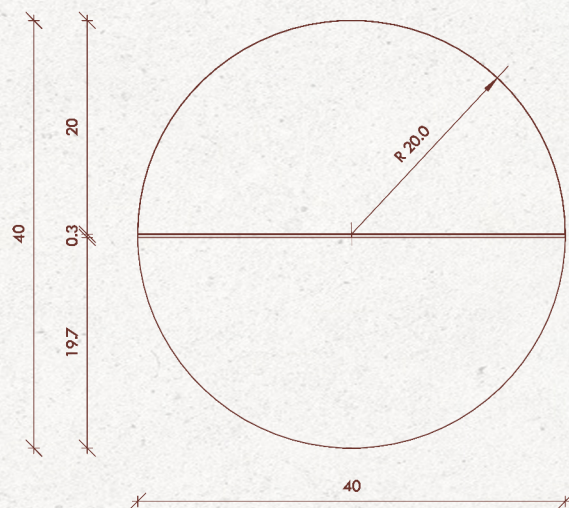

3D VIEW:

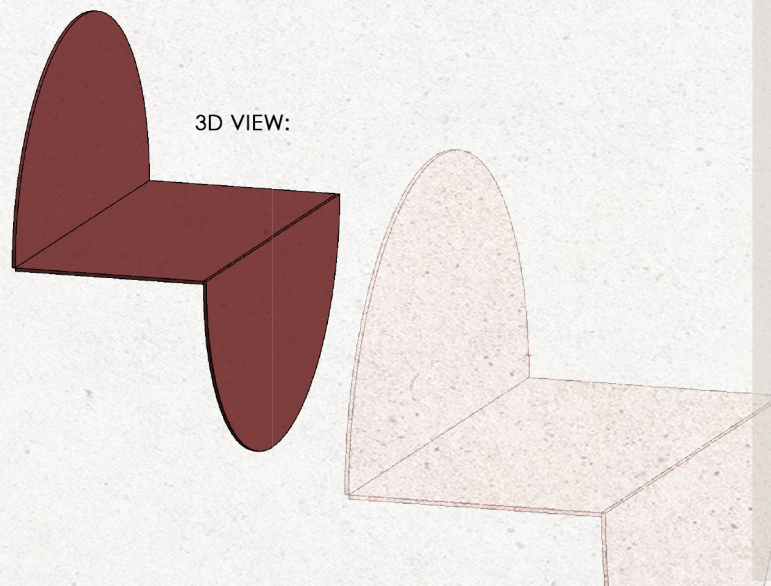

PRINT

or grab a coffee...



The interior spaces are crafted on the philosophy that design should embody the core principles of architecture: functionality, aesthetic appeal, and emotional impact. This vision comes to life through the interplay of oxide red—a central design theme—and the meticulous attention to each element, right down to the smallest details. The vibrant contrast between the rich, earthy red and the calm tones of white and black is all that's needed to create this minimalist yet invigorating environment.